

$$\frac{S}{B} = \frac{13}{130} = \frac{x}{90}$$

$$\frac{130x}{130} = \frac{1170}{130}$$

$$x = 39 \text{ units}$$

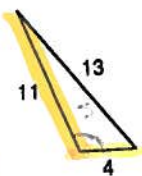
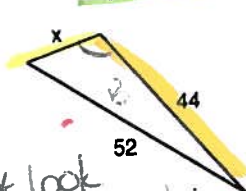

\* look at angles!

$$\frac{B}{S} = \frac{x}{4} = \frac{44}{11}$$

$$\frac{11x}{11} = \frac{176}{11}$$

$$x = 16 \text{ units}$$

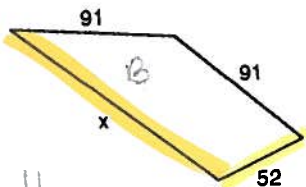
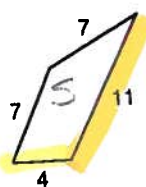

$$\frac{S}{B} = \frac{4}{52} = \frac{11}{x}$$

$$4x = 572$$

$$x = 143 \text{ units}$$

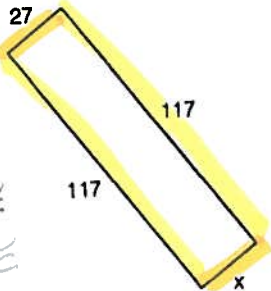
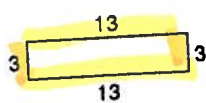

$$x = 27$$

angles are  $\cong$   
sides are  $\cong$

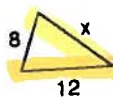

$$\frac{B}{S} = \frac{x}{3} = \frac{12}{3}$$

$$3x = 36$$

$$x = 12 \text{ units}$$

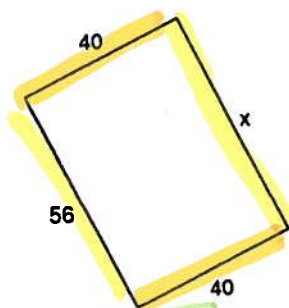

$$x = 56$$

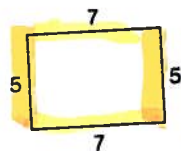

$$x = 14$$

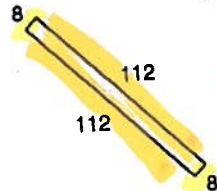

use angles + lines to help match

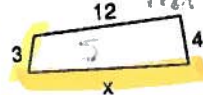
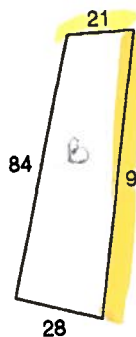

$$\frac{B}{S} = \frac{21}{3} = \frac{91}{x}$$

$$\frac{91x}{21} = \frac{273}{21}$$

$$x = 3 \text{ units}$$